

FEATURES

- ✘ Compact-sized 2.8x3.8mm
- ✘ Vertical or side actuation
- ✘ Wide stem

APPLICATION

- ✘ Automotive
- ✘ Portable electronic device
- ✘ Control panel

SPECIFICATION

Contact Rating	50mA, 12V DC
Contact Resistance	100mΩ max.
Insulation Resistance	100MΩ min. 500V DC
Dielectric Strength	100V AC/1 minute
Operating Force	100±50gf, 160±50gf (Vertical Push) 200±65gf (Side Push) 400±80gf (Vertical Push)
Travel	0.13mm (Vertical Push) 0.20mm (Side Push)
Operating Life	50,000 cycles for 400gf 100,000 cycles for 100/160/200gf
Operating Temp.	-20°C ~ +70°C
Storage Temp.	-30°C ~ +80°C

HOW TO ORDER

I P T □ □ □ □ - □ - □ - □

□=Without Ground Pin (For Vertical Push)
G=With Ground Pin

□=Without Post
P=With Post

Height for Vertical Push:
1=Side Push
2=Vertical Push H: 1.9mm
3=Vertical Push H: 2.5mm

Package:
T/R=Tape & Reel

V=RoHS & Lead Free Solderable
Q=Halogen Free

Contact Material:
□=Silver
A=Gold

Actuator Color:
K=Black
W=White

Operation Force:
2=100gf (Only for Vertical Push)
3=160gf (Only for Vertical Push)
4=200gf (Only for Side Push)
6=400gf (Only for Vertical Push)

CIRCUIT

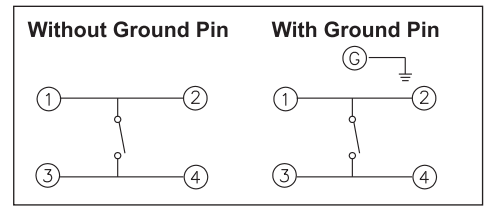

PACKAGE

<Tape & Reel>
IPTG14: 3500 pcs
IPTG23: 7000 pcs
IPTG33: 6300 pcs

IPTG

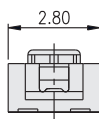
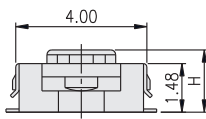
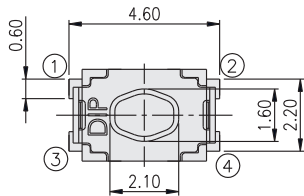

PART NO.	H
IPTG2	1.90
IPTG3	2.50

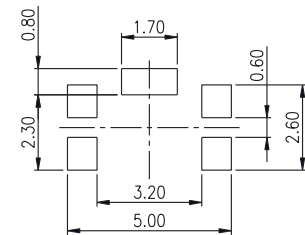

P.C.B. LAYOUT

IPTG1

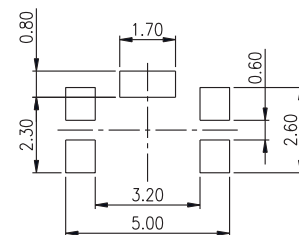
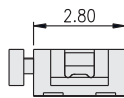
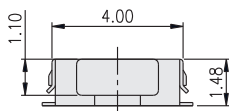
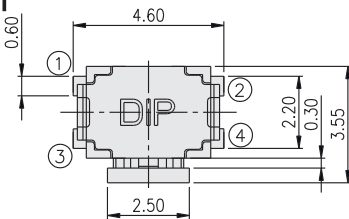

P.C.B. LAYOUT