

**FEATURES**

- ※Electrical life: 200,000 cycles
- ※Sharp click feeling
- ※2.7x3.0mm miniature tact switch

**APPLICATION**

- ※Automotive
- ※Video game device

**SPECIFICATION**

Contact Rating	50mA, 12V DC
Contact Resistance	100mΩ max.
Insulation Resistance	100MΩ min. 500V DC
Dielectric Strength	250V AC/1 minute
Operating Force	160±50gf/200±50gf/400±80gf
Travel	0.12mm
Operating Life	200,000 cycles
Operating Temp.	-40°C ~ +85°C
Storage Temp.	-40°C ~ +90°C

**CIRCUIT**

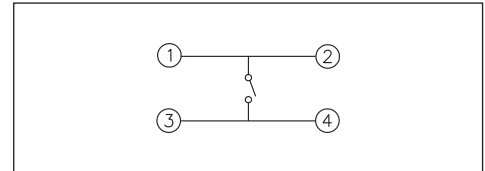

**PACKAGE**

<Tape & Reel>  
8000 pcs

**HOW TO ORDER**

T B E □ - □ - Q - □

G=With Ground Pin  
□=Without Ground Pin

Package:  
T/R=Tape & Reel

Halogen Free

Operating Force:  
N=Brown, 160gf  
W=White, 200gf  
□=Black, 400gf

TACT SWITCH

**TBE**

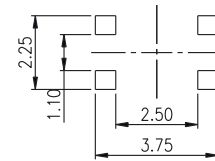
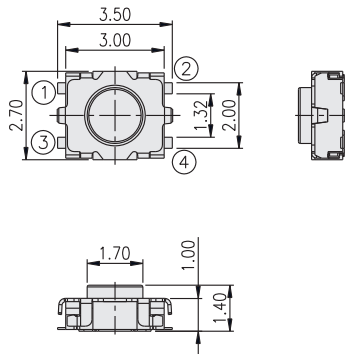

P.C.B. LAYOUT

**TBEG**

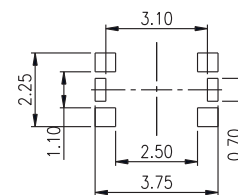
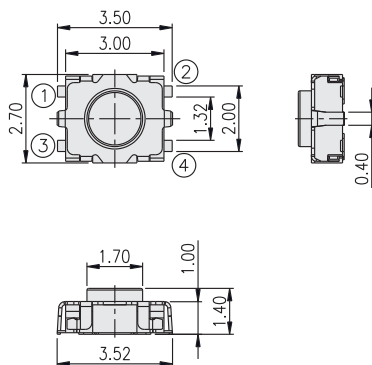

P.C.B. LAYOUT