

D-SUBMINIATURE CONNECTORS:
KF22X Series
 Right Angle PCB Mount 0.318" Footprint with Ferrite

KF22X Series Dimensions
 Dimensions in mm

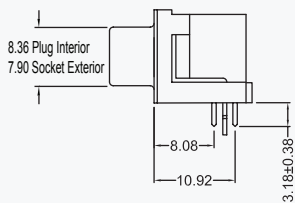
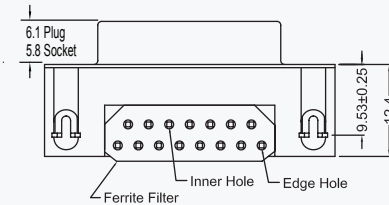
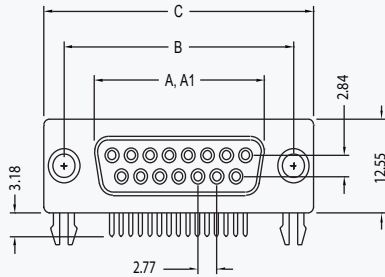

Shell Size	In mm				
	A	A1	B	C	
9 (E)	.643 16.33	.666 16.92	.984 24.99	1.213 30.81	±.010 ±0.25
15 (A)	.971 24.66	.994 25.25	1.312 33.32	1.541 39.14	±.010 ±0.25
25 (B)	1.511 38.38	1.534 38.96	1.852 47.04	2.088 53.04	±.005 ±0.13
37 (C)	2.159 54.84	2.182 55.42	2.500 63.50	2.729 69.32	±.015 ±0.38

A = Exterior of Female Shell (S)
 A1 = Interior of Male Shell (P)

2D Drawing	IGES	STEP	3D PDF
Solder Profile	CofC RoHS Compliant	CofC REACH Compliant	UL Plastic File
Certificate of Origin	Check Stock	Request a Sample	Send Us An Email

Generated Part Number



Part Number Builder

Series - Shell Size Contact - Contact Type - Mounting Option - Plating Option

Series

KF22X - D-Subminiature Connector, 0.318" Footprint with Ferrite

Shell Size-Contact Option

- E - 9 Contacts
- A - 15 Contacts
- B - 25 Contacts
- C - 37 Contacts

Contact Type

- P - Pin Contact (Plug)
- S - Socket Contact (Receptacle)

Mounting Option

- N - With Boardlocks and #4-40 UNC Threaded Inserts
- NJ - With Boardlocks and #4-40 Jackscrews Installed

Plating Option

- Blank - Gold Flash
- 30 - 30µ" Gold

Contact Kycon for Other Options