

## UNIVERSAL SERIAL BUS: KUSBVX Series

### Vertical Top Entry USB 3.0

#### Product Features

Also Known as SuperSpeed USB  
 Vertical Top Entry, Through Hole Termination  
 A Type Available  
 Meets USB-IF 3.0 Specifications  
 Backwards and Forward Compatible to USB 2.0 Products  
 CSA/NRTL Certified File No. LR78160

#### Performance Specifications

##### Materials and Finish

**Insulator**  
 PBT+30%GF Thermoplastic, UL 94V-0 Rated, Blue Color

##### Contact A(4 Pin)

Phosphor Bronze

##### Contact B(5 Pin)

Brass

##### Plating

30µ" Gold Plating over Nickel on Contact area,  
 Tin Plating on Solder Tail

##### Shell

Brass, Nickel Plated

#### Mechanical Characteristics

**Insertion Force:** 2.57kg Max.

**Extraction Force:** 1.0-2.5kg Min.

**Durability:** 5000 Cycles Min.

**Operating Temperature:** See Drawing

#### Electrical Characteristics

**Rated Current:** 1.8A

**Insulation Resistance:** 1000 Megohms

**Contact Resistance:** 50 milliohms Max

**Dielectric Withstanding Voltage:** 100V AC for 1 Minute

|                       |                     |                      |                  |
|-----------------------|---------------------|----------------------|------------------|
| 2D Drawing            | IGES                | STEP                 | 3D PDF           |
| Solder Profile        | CofC RoHS Compliant | CofC REACH Compliant | UL Plastic File  |
| Certificate of Origin | Check Stock         | Request a Sample     | Send Us An Email |

#### Generated Part Number

#### Part Number Builder



#### Series

**KUSBVX** - Vertical Top Entry Universal Serial Bus

#### Type

**BS1N9** - B Type, 9 Pins

#### Insulator Color Option

**BL** - Blue

#### Plating Option

**30** - 30µ" Gold Plating

Contact Kycon for other options

### KUSBVX-BS1N9-BL30

Dimensions in mm

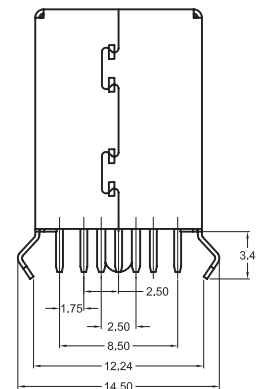
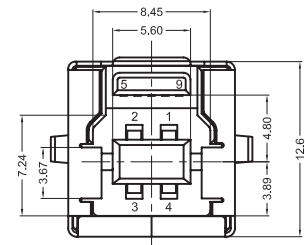
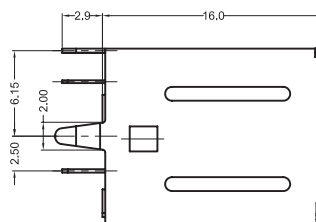

| Pin Number | Signal Name |
|------------|-------------|
| 1          | VBUS        |
| 2          | D-          |
| 3          | D+          |
| 4          | GND         |
| 5          | StdB_SSTX-  |
| 6          | StdB_SSTX+  |
| 7          | GND-DRAIN   |
| 8          | StdB_SSRX-  |
| 9          | StdB_SSRX+  |