

OBO Pro.2

SPECIFICATIONS

MODEL NO
OBO-15008S-02

PART NAME
DYNAMIC SPEAKER

SHEET
1 OF 7

ALTERNATION HISTORY

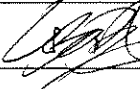
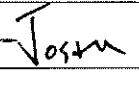
Marking	Date	ECN NO.	REV.	Description	Page	PREPARE BY	APPROVE BY
---	FEB,02,2010	---	A	New Document	7		 Justin

REV.	DATE	PREPARED BY	CHECKED BY	APPROVED BY
A	FEB,02,2010			 Daniel

MODEL NO : OBO-15008S-02

Features:Conformity RoHS Directive(2002/95/EC) Requests.

1. General Specifications

Items	Spec
Type	Dynamic speaker
Dimension	External diameter 15*15*4 mm
Weight	1.5g ± 0.1g
Power Rating	Normal 0.5W,Maximum 1.0W
Impedance	8 ohm ± 15% at 1KHz
Resonance Frequency (Fo)	850 Hz ± 20%
Sensitivity (S.P.L.)	88± 3dB(0.5W/0.1M) at AVE 1.0K,1.2K,1.5K 2.0KHz
Frequency Range	Fo – 20KHz
Distortion	Less than 10 % at 2000Hz 0.5W
Magnet	Rare earth permanent (Nd-Fe-B) magnet Φ6.8 x 1.0mm
Abnormal Sound Test	Must be normal tested by 2.0Volt.sine wave
Polarity	When positive voltage is applied to the terminal marked (+), diaphragm should move to the front.
Operating Temperature	-40 ~ +85°C
Storage Temperature	-50 ~ +95°C

2. Environmental Test

Terminal Strength	Capable of withstand 1kg load for 30 seconds without resulting in any damage or rejection.
Load Test	0.5W white noise is applied for 96 hours and satisfy the test listed on item 05,06,13,15
High Temp. Test	Keep 96 hours at $+70^{\circ}\text{C} \pm 3^{\circ}\text{C}$ and leave 3 hours in normal temperature and then check
Low Temp. Test	Keep 96 hours at $-20^{\circ}\text{C} \pm 3^{\circ}\text{C}$ and leave 3 hours in normal temperature and then check
Humidity Test	Keep 96 hours at $+60^{\circ}\text{C} \pm 3^{\circ}\text{C}$ relative humidity 95% and leave 3 hours in normal temperature and then checked.
Drop Test	Drop the speakers contained in normal box onto the board 20mm thick 10 times from the height of 0.75m and then should satisfy the test listed on item 13 and 15

3.Soldering Condition

(1)Recommendable reflow soldering condition is as follows (Reflow soldering is twice)

Note:It is requested that reflow soldering should be executed after heat of product goes down to normal.

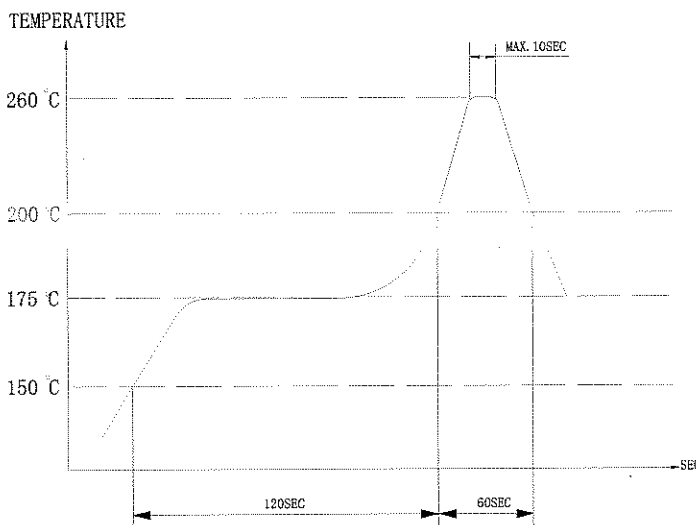

Heat resistant line (Used when heat resistant reliability test is performed)

(2)Manual soldering

Manual soldering temperature 350°C within 5 sec.

4. Mechanical Layout And Dimensions

4.1 Dimensions

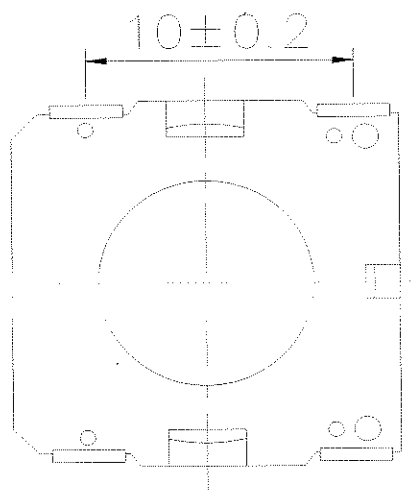
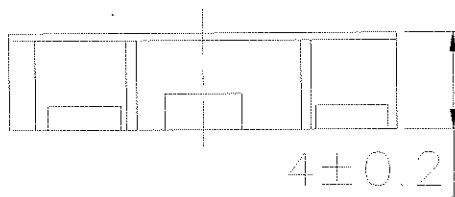
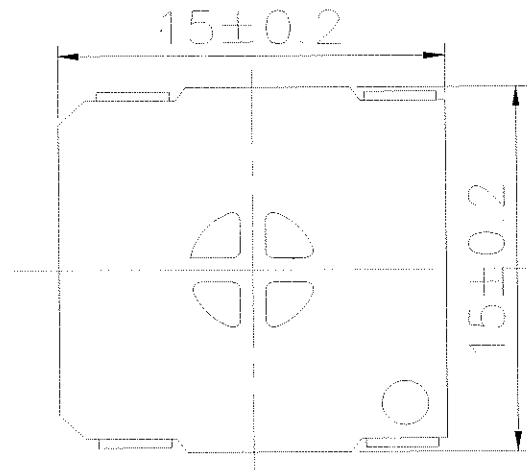

5. Test Method

5.1 Measurement Diagram

Electroacoustic
Testing Adapter

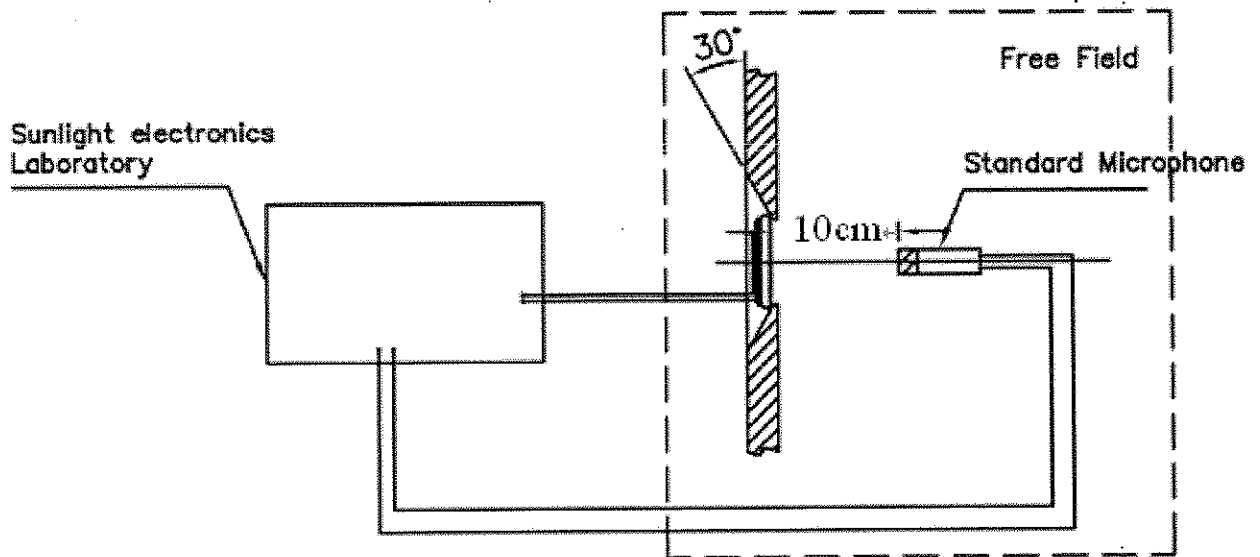

5.2 Standare Baffle

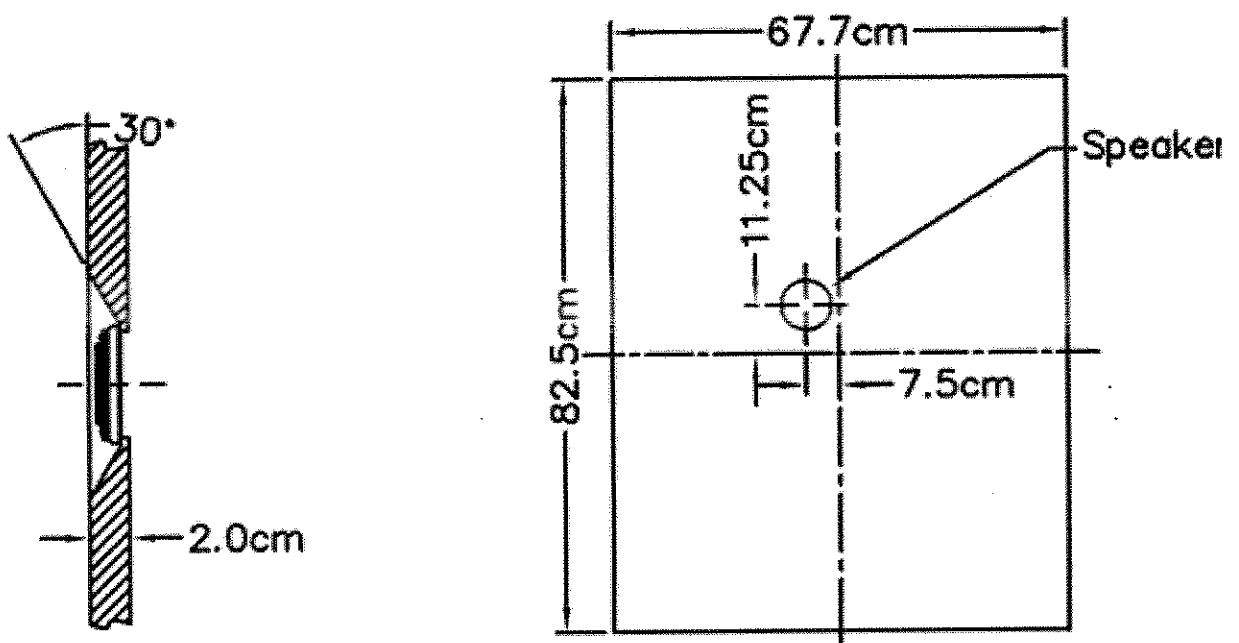

6. Frequency Response

Firm: OBU Model: DATE: 01-28-2010 TIME: 07:41:02
 100Hz Sens. = 90.9dB SPL Pass F.R.: Pass DCR: 0.630 Pass
 Average SPL: 00.6dB SPL Pass (1000:1200:1500; 2000Hz) Sweep Speed: 1/24 Oct.

B 6.18

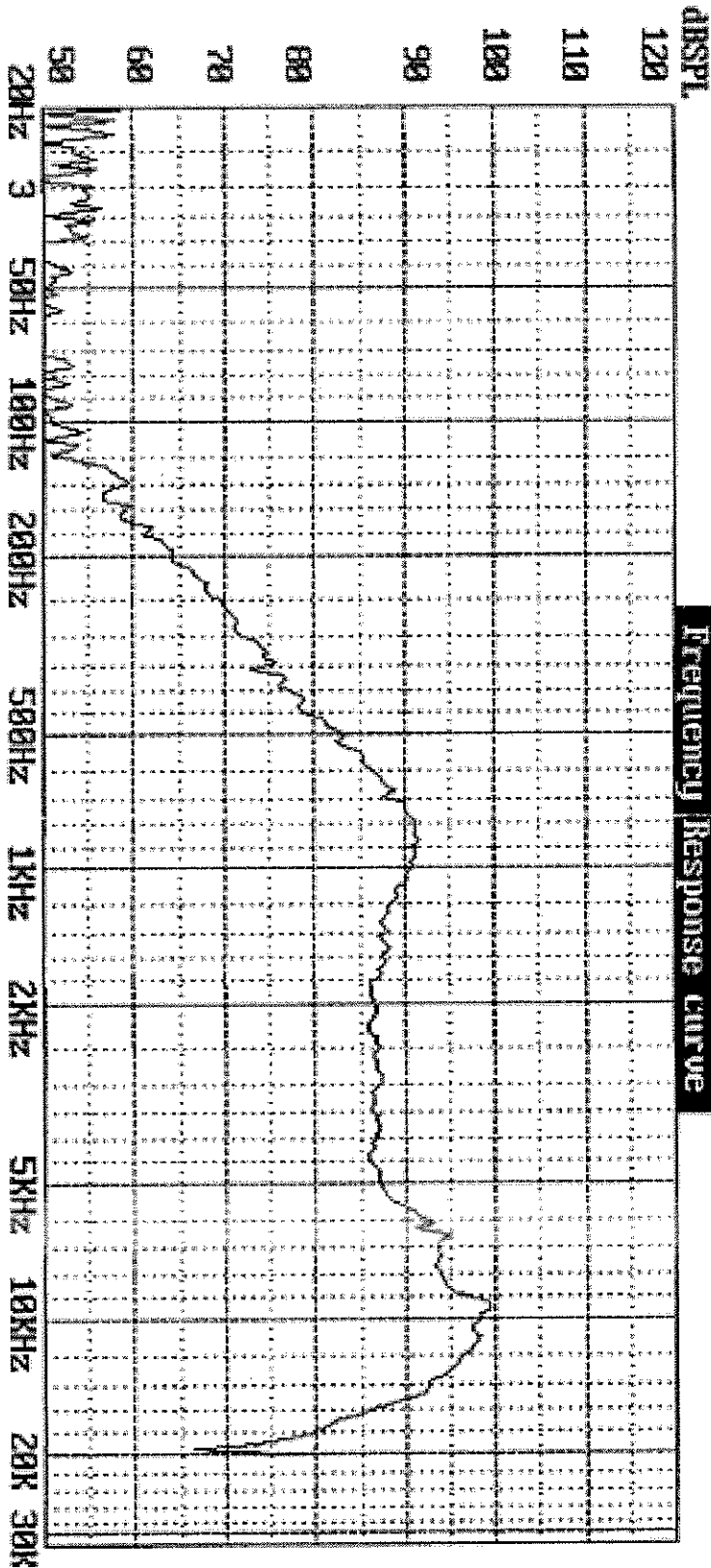

Voltage applied for F.R. = 2.000V Start F. = 20Hz Stop F. = 20000Hz
 Measuring Distance = 0.10M

Mfg.:

Measured using Sunlight 1600; Fax: 086-2-22230727

7. Packing

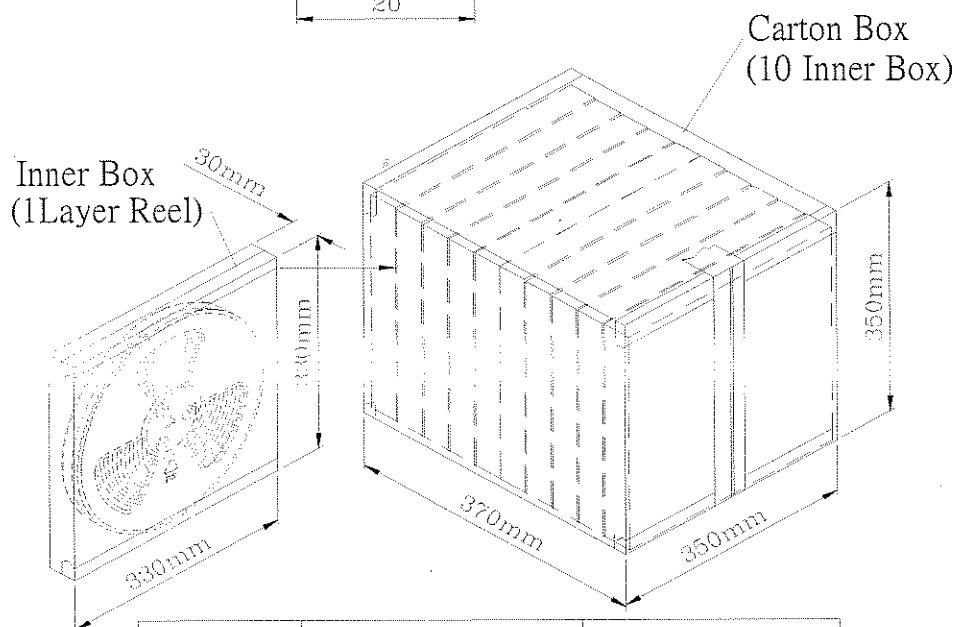
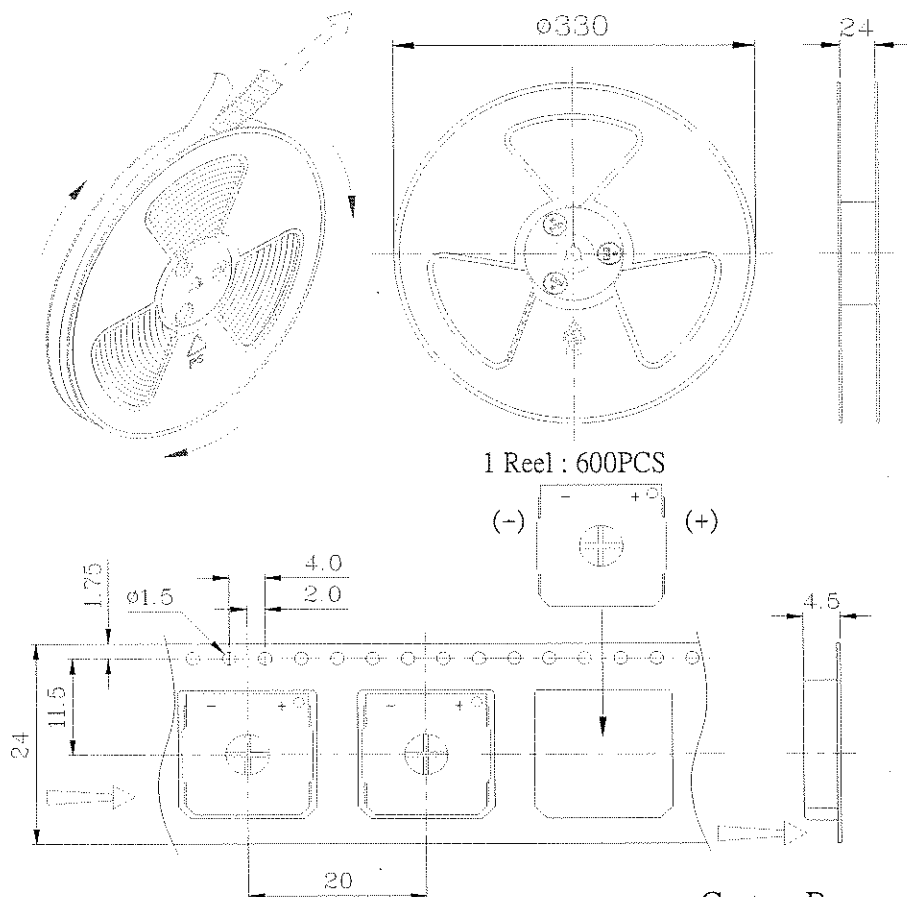

Inner Box	330mmx330mmx30mm	1x600PCS=600PCS
Carton Box	350mmx350mmx370mm	10x600PCS=6,000PCS