

SERIES INDEX

MORE INFO

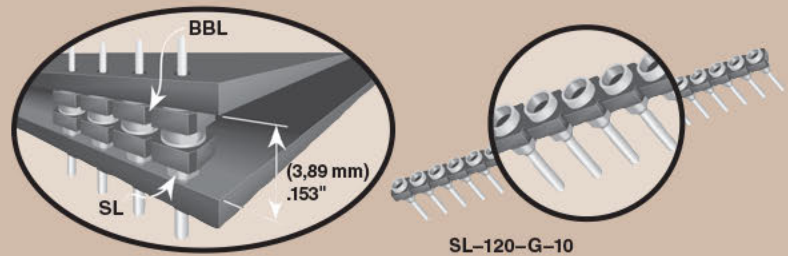

SL-120-G-10

SL, SDL SERIES

(2,54 mm) .100"

LOW PROFILE MACHINED SOCKET STRIPS

FEATURES

- Achieve low profile without sacrificing insertion depth!
- Choice of four precision screw machined lead styles.
- Exceptionally low profile, down to (2,11 mm) .083" off of board.
- Mates with BBL or BDL for board stacking spaces down to (3,89 mm) .153"

SPECIFICATIONS

For complete specifications see www.samtec.com?SL or www.samtec.com?SDL

Insulator Material: Black Glass Filled Polyester
Contact/Shell Materials: BeCu/Brass

Plating: Au or Sn over 50µ" (1,27 µm) Ni
Operating Temp Range: -55°C to +125°C with Gold
 -55°C to +105°C with Tin
Contact Resistance: 10 mΩ

Insertion Force: (Single contact only) Standard = 9 oz (2,50 N) avg., 16 oz (4,45 N) max ((0,43 mm) .017" DIA probe)

Low Insertion Force = 2.5 oz (0,70 N) avg., 5.5 oz (1,53 N) max ((0,43 mm) .017" DIA probe)

Withdrawal Force: (Single contact only) Standard = 2.5 oz (0,70 N) avg., 1.5 oz (0,42 N) min ((0,43 mm) .017" DIA probe)

Low Insertion Force = 2.0 oz (0,56 N) avg., 0.5 oz (0,14 N) min ((0,43 mm) .017" DIA probe)

RoHS Compliant: Yes
Lead-Free Solderable: Wave only

RECOGNITIONS

For complete scope of recognitions see www.samtec.com/quality



Note: Some lengths, styles and options are non-standard, non-returnable.

Mates with: TS, TD, HTS, BBS, BBD, BBL, BDL, BHS

TYPE STRIP

1

NO. PINS PER ROW

PLATING OPTION

LEAD STYLE

SL
= Single Row Low Profile Socket Strip

SDL
= Double Row Low Profile Socket Strip

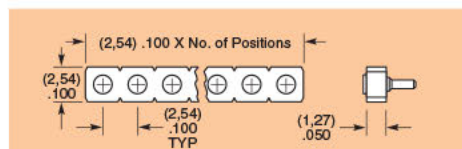

01 thru 32

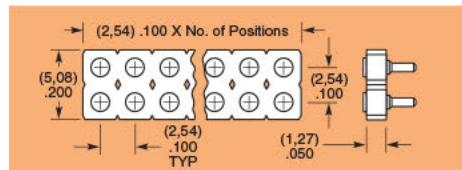

01 thru 36

-G
= 30µ" (0,76 µm) Gold contact, 10µ" (0,25µm) Gold shell

-T
= 30µ" (0,76 µm) Gold contact, Tin shell

-TT
= Tin contact and shell (LIF not available)

Low Insertion Force (LIF) Available

-10
Low Profile (Hollow Leg)

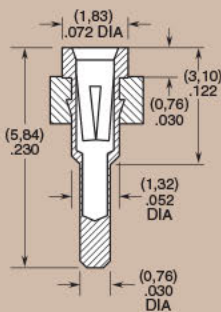

Contact Length = (2,11 mm) .083"
 Lead DIA Accepted = (0,38 mm) .015" to (0,51 mm) .020"
 Insertion Depth = (2,67 mm) .105" to (4,32 mm) .170"
 Style 10 Component Part No. = SC-3P1

-11
Low Profile (Standard Mount) For LIF specify -31

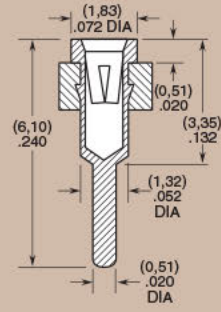

Contact Length = (1,58 mm) .062"
 Lead DIA Accepted = (0,41 mm) .016" to (0,53 mm) .021"
 Insertion Depth = (2,03 mm) .080" to (2,67 mm) .105"
 Style 11 Component Part No. = SC-4P1
 Style 31 Component Part No. = EZ-4P1

-12
Micro-Socket (Hollow Leg)

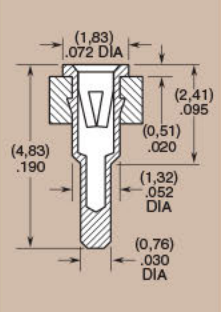

Contact Length = (1,58 mm) .062"
 Lead DIA Accepted = (0,41 mm) .016" to (0,51 mm) .020"
 Insertion Depth = (1,65 mm) .065" to (3,81 mm) .150"
 Style 12 Component Part No. = SC-5P1

-19
Micro-Socket (Hollow Leg) For LIF specify -39

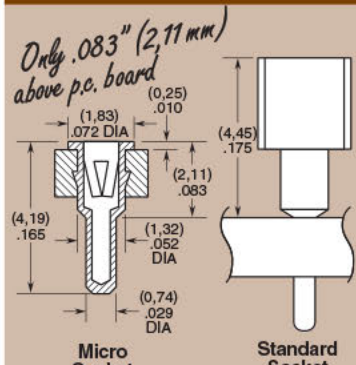

Micro Socket
 Contact Length = (1,58 mm) .062"
 Lead DIA Accepted = (0,41 mm) .016" to (0,51 mm) .020"
 Insertion Depth = (1,65 mm) .065" to (3,56 mm) .140"
 Style 19 Component Part No. = SC-8P1
 Style 39 Component Part No. = EZ-8P1

Standard Socket
 (Reference only. Not available with SL & SDL)

Due to technical progress, all designs, specifications and components are subject to change without notice.

WWW.SAMTEC.COM

PRECISION MACHINED SOCKET STRIPS

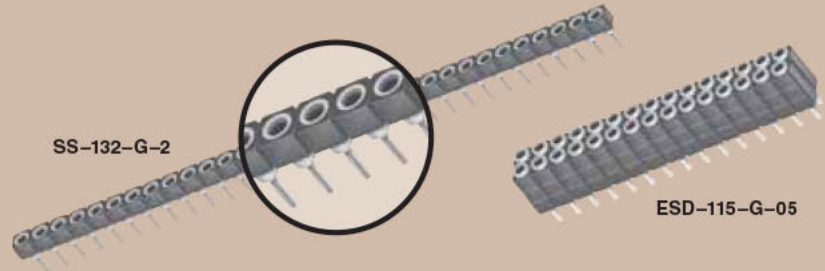

Mates with:
TS, TD, HTS, BBS,
BBD, BBL, BDL, BHS

SPECIFICATIONS

For complete specifications see www.samtec.com?SS, www.samtec.com?ESS, www.samtec.com?SD, www.samtec.com?ESD or www.samtec.com?HSS

Insulator Material:
SS, SD, ESS, ESD= Black G.F. Polyester
HSS= Black Liquid Crystal Polymer

Contact:
BeCu
Shell:
Brass except Style 5A
Phosphor Bronze

Plating:
Au over 50µ" (1,27 µm) Ni or Sn over 50µ" (1,27 µm) Ni

Operating Temp Range:
-55°C to +125°C

Contact Resistance:
10 mΩ

Lead Size Range:
(0,38 mm to 0,56 mm)
.015" to .022" DIA and most IC leads

Insertion Force:
(Single contact only)
Standard=

9 oz (2,50 N) avg.,

16 oz (4,45 N) max

Low Insertion Force=

2.5 oz (0,70 N) avg.,

5.5 oz (1,53 N) max

Withdrawal Force:
(Single contact only)
Standard=

2.5 oz (0,70 N) avg.,

1.5 oz (0,42 N) min

Low Insertion Force=

2.0 oz (0,56 N) avg.,

0.35 oz (0,10 N) min

Insertion Depth:
(-05, -1X & -21X, -5A)

(3,18 mm) .125" to (3,99 mm) .157"

Insertion Depth:
(-2, -22, -38)

(2,41 mm) .095" to (3,68 mm) .145"

RoHS Compliant:
Yes

Lead-Free Solderable:
Wave only

RECOGNITIONS

For complete scope of recognitions see www.samtec.com/quality



FILE NO. 011194

TYPE STRIP	1	NO. PINS PER ROW	PLATING OPTION	LEAD STYLE	OPTION	OTHER OPTION
		01 thru 32 =SS, ESS Series	-S = 10µ" (0,25 µm) Gold contact, Tin shell (Styles 2 & 22 only)		-L = Locking Socket Add -L suffix for locking lead socket in end positions. Requires Style -2 or -22 and .035" ± .003 DIA board hole.	-N = Non Flush
		01 thru 36 =HSS, SD & ESD Series	-T = 30µ" (0,76 µm) Gold contact, Tin shell		Requires -T Plating Option	N/A Style -5A
	SS = Standard Single Row Socket	HSS = High Temp Single Row Socket	-G = 30µ" (0,76 µm) Gold contact, 10µ" (0,25 µm) Gold shell			
	ESS = Elevated Single Row Socket		-TT = Tin contact and shell (Styles 1, 2, 4, and 05 except LIF N/A)		ALSO AVAILABLE (MOQ Required)	
	SD = Standard Double Row Socket				• Locking lead option on ESS and ESD series Contact Samtec.	
	ESD = Elevated Double Row Socket					

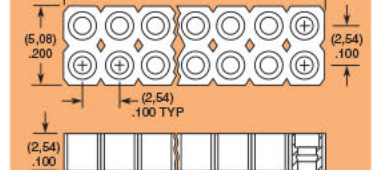
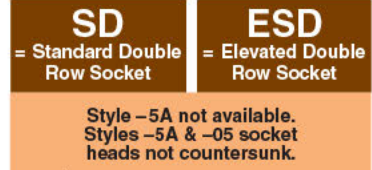
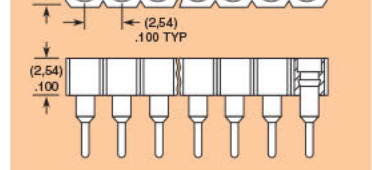

LIF= Low Insertion Force

Note:
Some lengths, styles and options are non-standard, non-returnable.

-1A, -1B or -1C
For LIF specify -21A, -21B or -21C (SS, HSS, SD)

LEAD STYLE	Y
-1A or -21A	(9,14) .360
-1B or -21B	(12,95) .510
-1C or -21C	(6,60) .260

-03, -04, -05
For LIF specify -23 (ESS, ESD)

-2, -22*, -5A, or -38*
*For LIF specify -22 or -38 (SS, HSS, SD)

LEAD STYLE	X DIA	Y	Z
-2 or -22	(0,51) .020	(3,18) .125	(7,62) .300
-38	(0,51) .020	(4,57) .180	(8,89) .350
-5A	(0,89) .035	(12,95) .510	(17,86) .703

Locking lead available. See OPTION.

LEAD STYLE	A	B	C
05	(17,86) .703	(13,46) .530	(4,39) .173
03 or 23	(11,51) .453	(8,38) .330	(3,12) .123
04	(14,05) .553	(10,92) .430	(3,12) .123

Due to technical progress, all designs, specifications and components are subject to change without notice.

SERIES INDEX

MORE INFO

(2,54 mm) .100"

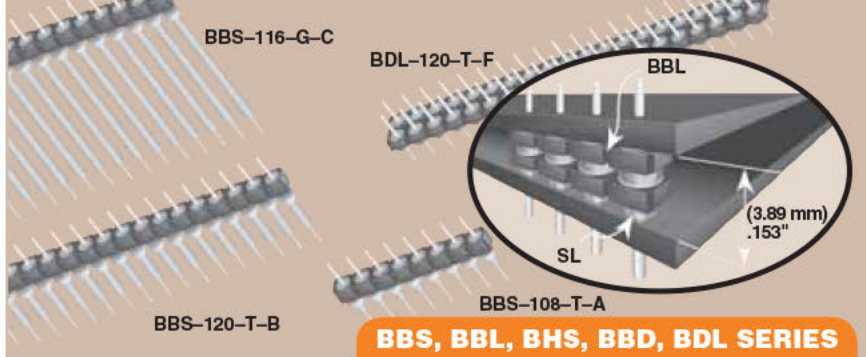

BBS, BBL, BHS, BBD, BDL SERIES

MACHINED BOARD STACKING STRIPS

Mates with:
SS, SD, HSS, SL, SDL,
ESS, ESD

FEATURES

- Low profile design achieves (3,89 mm) .153" board spacings when mated with SL Series.
- Approach the reliability of a permanent connection with the flexibility of a separable connection.

SPECIFICATIONS

For complete specifications see www.samtec.com?BBS, www.samtec.com?BBL, www.samtec.com?BHS, www.samtec.com?BBD or www.samtec.com?BDL

Insulator Material:
Black Glass Filled Polyester (BBS, BBD, BBL)
Black High Temp Nylon (BDL)
Black Liquid Crystal Polymer (BHS)

Temperature Range:
-55°C to +125°C

Terminal Material:
Phosphor Bronze or Brass

Plating:
Au or Sn over 50µ" (1,27 µm) Ni
RoHS Compliant:
Yes

Lead-Free Solderable:
Wave only (BBS, BBD, BBL, BDL)
Wave, or reflow with all Au (BHS)

RECOGNITIONS

For complete scope of recognitions see www.samtec.com/quality



Note: Some lengths, styles and options are non-standard, non-returnable.

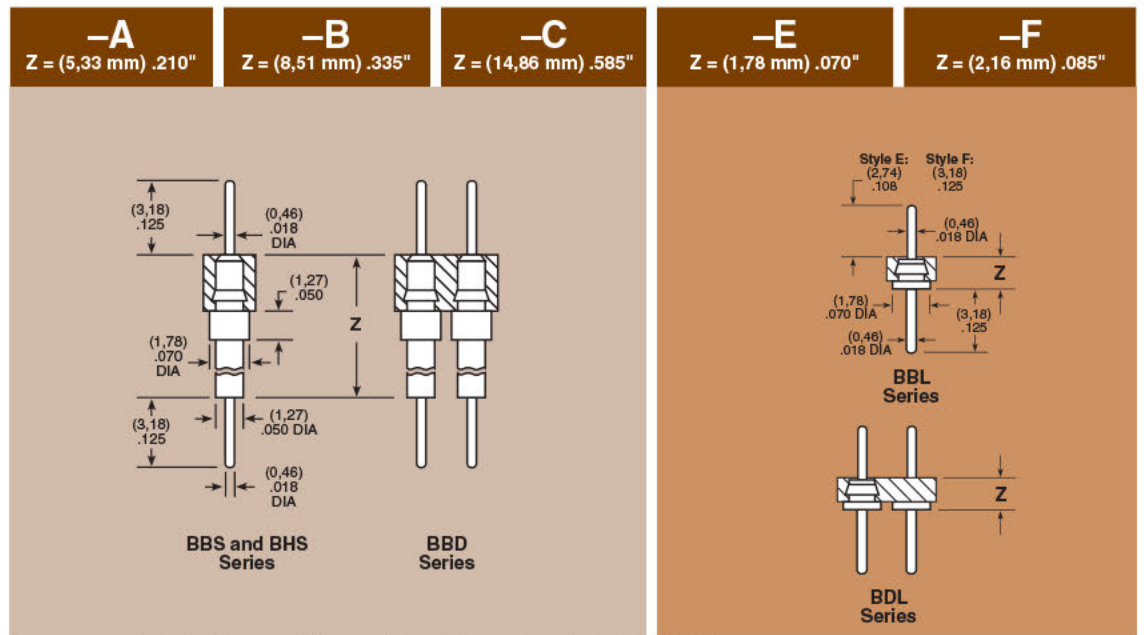
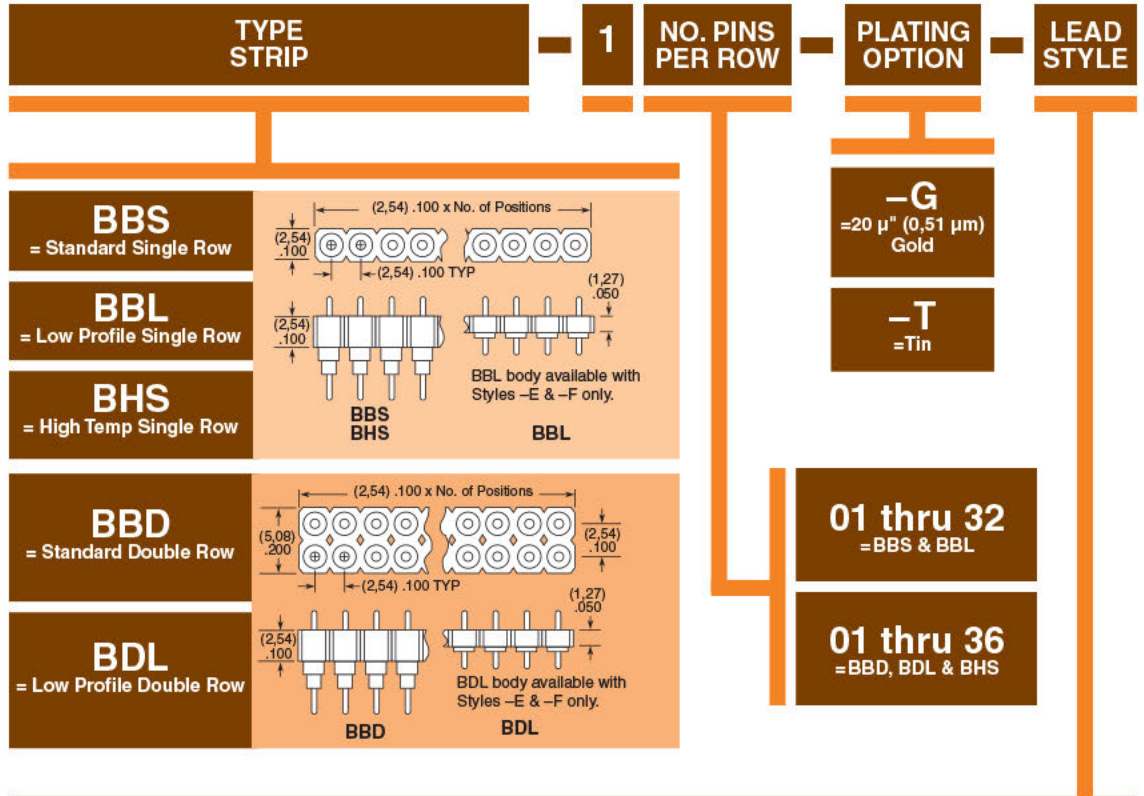

Due to technical progress, all designs, specifications and components are subject to change without notice.

WWW.SAMTEC.COM

SERIES INDEX

MORE INFO

(2,54 mm) .100"

TS, TD, HTS SERIES

PRECISION MACHINED TERMINAL STRIPS

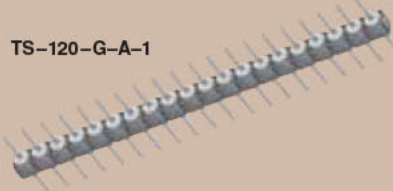

TS-120-G-A-1



TD-108-G-AA

SPECIFICATIONS

For complete specifications see www.samtec.com?TS, www.samtec.com?TD or www.samtec.com?HTS

Insulator Material:
Black G.F. Polyester (TS, TD)
Black Liquid Crystal Polymer (HTS)

Terminal Material:
Brass, except Style G is Phosphor Bronze

Plating:
Au over 50µ" (1,27 µm) Ni or Sn over 100µ" (2,54 µm) Cu or 50µ" (1,27 µm) Ni

Operating Temp Range:
-55°C to +125°C with Gold
-55°C to +105°C with Tin

RoHS Compliant:
Yes

Lead-Free Solderable:
Wave only

RECOGNITIONS

For complete scope of recognitions see www.samtec.com/quality



Mates with:
SS, SD, HSS, SL,
SDL, ESS, ESD

Note: Some lengths, styles and options are non-standard, non-returnable.

TYPE STRIP

1

NO. PINS PER ROW

PLATING OPTION

LEAD STYLE

TS
= Single Row Terminal Strip

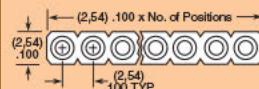

HTS
= Single Row High Temp Terminal Strip

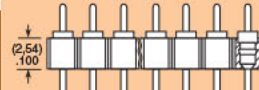

TD
= Double Row Terminal Strip

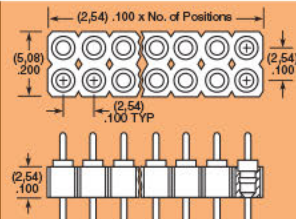

-G
= 20µ" (0,51 µm) Gold
Except -J & -L are 10µ" (0,25 µm) Gold

-T
= Tin

01 thru 32
= TS Series

01 thru 36
= HTS & TD Series

-AA

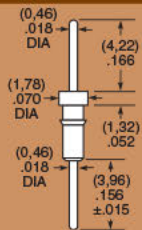

Component No. = T-1R5-

-A, -A-1, -A-2

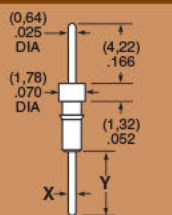

-A Component No. = T-1R0-
-A-X Component No. = T-1R7

LEAD STYLE	X (DIA)	Y (±.015)
-A	(0,46) .018	(3,96) .156
-A-1	(0,64) .025	(5,33) .210
-A-2	(0,89) .035	(5,33) .210

-C, -C-1, -C-2

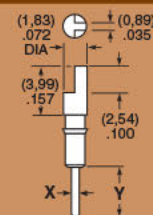

-C Component No. = T-1R2-
-C-X Component No. = T-1R9-

LEAD STYLE	X (DIA)	Y (±.015)
-C	(0,46) .018	(3,96) .156
-C-1	(0,64) .025	(5,33) .210
-C-2	(0,89) .035	(5,33) .210

-G-1

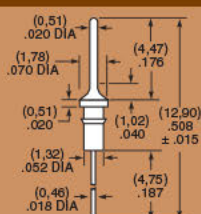

Component No. = T-1R5-

-J

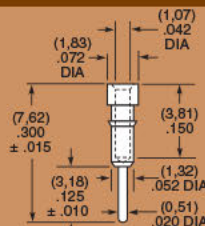

Component No. = S-1P1-

-L-1, -L-2, -L-3

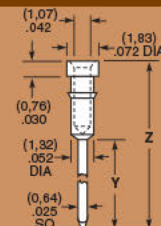

Component No. = S-1W1

LEAD STYLE	Y (DIA)	Z (±.015)
-L-1	(12,95) .510	(17,86) .703
-L-2	(9,14) .360	(14,05) .553
-L-3	(6,60) .260	(11,51) .453

Due to technical progress, all designs, specifications and components are subject to change without notice.

WWW.SAMTEC.COM