

## SMPM TO 65 GHz

### SMPM Ganged Block: GPPB

Mates With: PRFIA

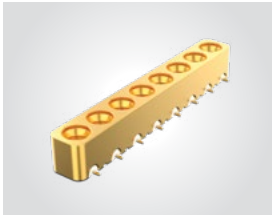

GPPB	GENDER	NO. OF ROWS	NO. OF POSITIONS	PLATING	ST	SM	CHANNEL PITCH
------	--------	-------------	------------------	---------	----	----	---------------

- PF**  
= Plug Full Detent
- PS**  
= Plug Smooth Bore
- PC**  
= Catcher's Mitt
- 1**
- 02, -04, -06, -08, -10**
- EG**  
= 50 μ" (1.27 μm) heavy Gold center contact, 10 μ" (0.25 μm) Gold outer body
- 1N**  
= 3.56 mm (.140") Pitch

**-PC**  
PRELIMINARY

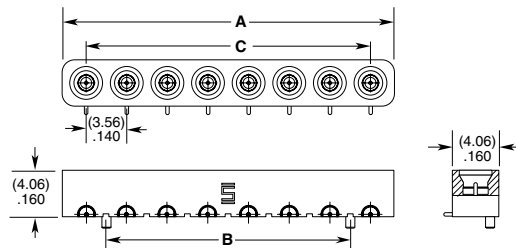

NO. OF POSITIONS	A	B	C
-02	(7.62) .300	N/A	(3.56) .140
-04	(14.73) .580	(7.11) .280	(10.67) .420
-06	(21.84) .860	(14.22) .560	(17.78) .700
-08	(28.96) 1.14	(21.34) .840	(24.89) .980
-10	(36.07) 1.42	(28.45) 1.12	(32.00) 1.26

### ALSO AVAILABLE

2, 4, 6, 10 Positions Counts  
 (8.33 mm) .328" Pitch  
 (5.08 mm) .200" Pitch  
 Edge Mount termination  
 Contact [RFGroup@samtec.com](mailto:RFGroup@samtec.com)

**-PF-1-08-EG-ST-SM-1N SHOWN**

### SMPM In-Series Adaptor: PRFIA

Mates With: SMPM, GPPB, GPPC



### VSWR

1.50 max.

PRFIA	SMPM	GENDER	GENDER	ORIENTATION	OPTION
-------	------	--------	--------	-------------	--------

- J**  
= Jack
- J**  
= Jack
- S**  
= Straight
- 1**  
= (5.33) .210
- 2**  
= (8.31) .327
- 3**  
= (12.70) .500
- 4**  
= (4.22) .166

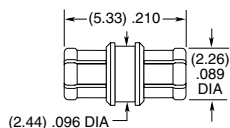

**OPTION 1**

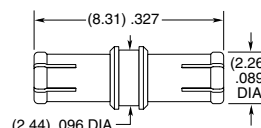

**OPTION 2**

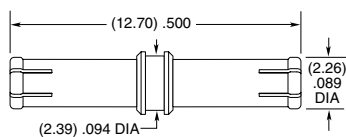

**OPTION 3**

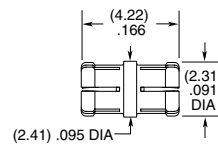

**OPTION 4**

# PRECISION RF ADAPTORS

## In-Series Adaptors PRFIA



### VSWR

-185: 1.25 max.  
-240: 1.15 max.  
-292: 1.15 max.

PRFIA	CONNECTOR	END 1 GENDER	END 2 GENDER	ORIENTATION	1
	-185 = 1.85 mm	-P = Plug	-P = Plug (Only available with -P on end 1)	-S = Straight	Required for -292 Jack-to-Jack adaptor (PRFIA-292-J-J-S-1)  Leave blank for all other part numbers.
	-240 = 2.40 mm	-J = Jack	-J = Jack		
	-292 = 2.92 mm				
<b>PRFIA-185-J-J-S</b>	<b>PRFIA-185-P-J-S</b>	<b>PRFIA-240-P-P-S</b>	<b>PRFIA-292-J-J-S-1</b>	<b>PRFIA-292-P-P-S</b>	

\* SMPM in-series PRFIA adaptors available. See SMPM section, or visit [samtec.com/SMPM](http://samtec.com/SMPM)

## Between-Series Adaptors PRFBA



### VSWR

1.30 max.

PRFBA	CONNECTOR	END 1 GENDER	CONNECTOR	END 2 GENDER	ORIENTATION	1
	-292 = 2.92 mm	-P = Plug	-SMPM	-J = Jack	-S = Straight	Required for Jack-to-Jack adaptor (PRFBA-J-SMPM-J-S-1)  Leave blank for all other part numbers.
		-J = Jack		-PF = Plug Full Detent		
<b>PRFBA-292-J-SMPM-J-S-1</b>	<b>PRFBA-292-J-SMPM-PF-S</b>	<b>PRFBA-292-P-SMPM-J-S</b>	<b>PRFBA-292-P-SMPM-PF-S</b>			

# PRECISION RF ADAPTORS

## In-Series Adaptors PRFIA



### VSWR

-185: 1.25 max.  
-240: 1.15 max.  
-292: 1.15 max.

PRFIA	CONNECTOR	END 1 GENDER	END 2 GENDER	ORIENTATION	1
	-185 = 1.85 mm	-P = Plug	-P = Plug (Only available with -P on end 1)	-S = Straight	Required for -292 Jack-to-Jack adaptor (PRFIA-292-J-J-S-1)  Leave blank for all other part numbers.
	-240 = 2.40 mm	-J = Jack			
	-292 = 2.92 mm		-J = Jack		
	<b>PRFIA-185-J-J-S</b>			<b>PRFIA-292-J-J-S-1</b>	
	<b>PRFIA-185-P-J-S</b>			<b>PRFIA-292-P-J-S</b>	
	<b>PRFIA-240-P-P-S</b>			<b>PRFIA-292-P-P-S</b>	

\* SMPM in-series PRFIA adaptors available. See SMPM section, or visit [samtec.com/SMPM](http://samtec.com/SMPM)

## Between-Series Adaptors PRFBA



### VSWR

1.30 max.

PRFBA	CONNECTOR	END 1 GENDER	CONNECTOR	END 2 GENDER	ORIENTATION	1
	-292 = 2.92 mm	-P = Plug	-SMPM	-J = Jack	-S = Straight	Required for Jack-to-Jack adaptor (PRFBA-J-SMPM-J-S-1)  Leave blank for all other part numbers.
		-J = Jack		-PF = Plug Full Detent		
	<b>PRFBA-292-J-SMPM-J-S-1</b>		<b>PRFBA-292-P-SMPM-J-S</b>			
	<b>PRFBA-292-J-SMPM-PF-S</b>		<b>PRFBA-292-P-SMPM-PF-S</b>			

# PRECISION RF ADAPTORS

## In-Series Adaptors PRFIA



### VSWR

-185: 1.25 max.  
-240: 1.15 max.  
-292: 1.15 max.

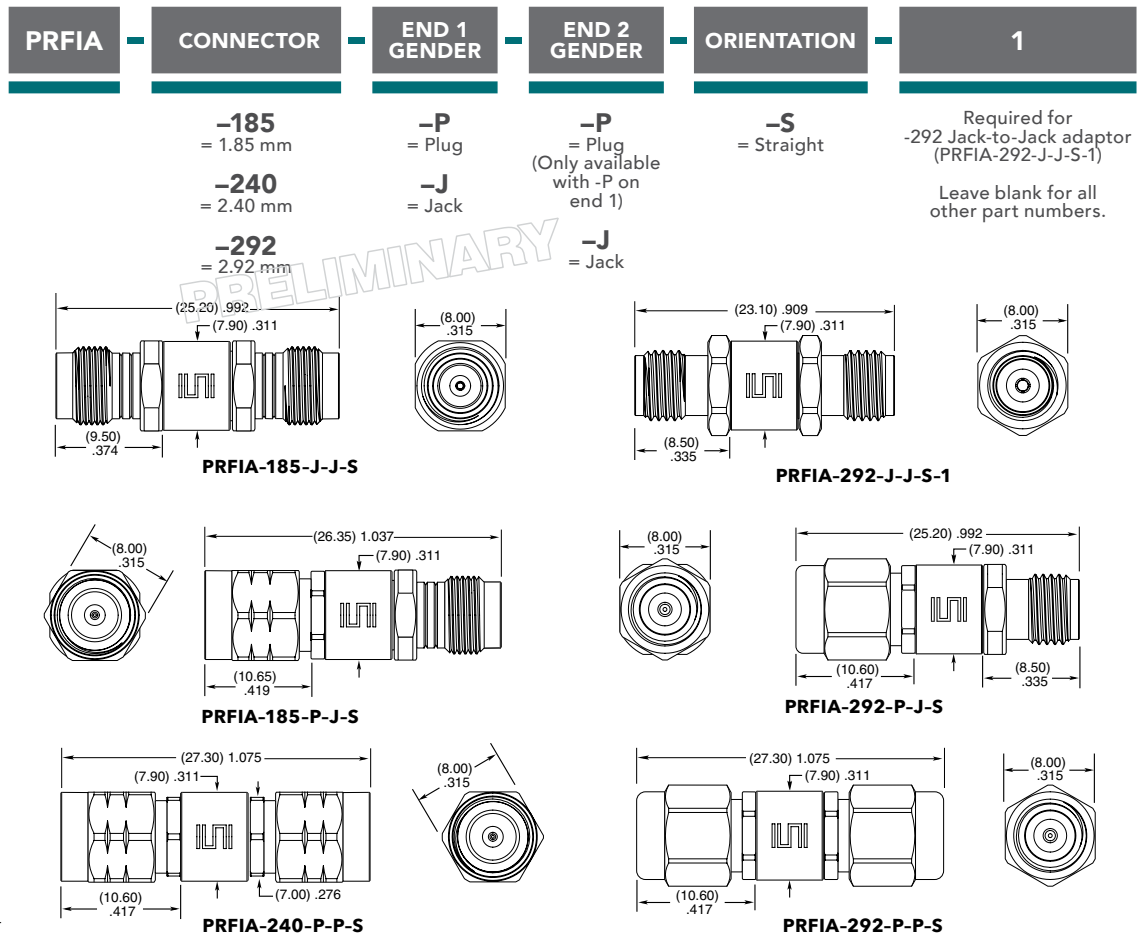

\* SMPM in-series PRFIA adaptors available. See SMPM section, or visit [samtec.com/SMPM](http://samtec.com/SMPM)

## Between-Series Adaptors PRFBA



### VSWR

1.30 max.

